

jazzahead! 2019

Preliminary hall plan
updated: 29.08.2018 14:22:17

Hall 6

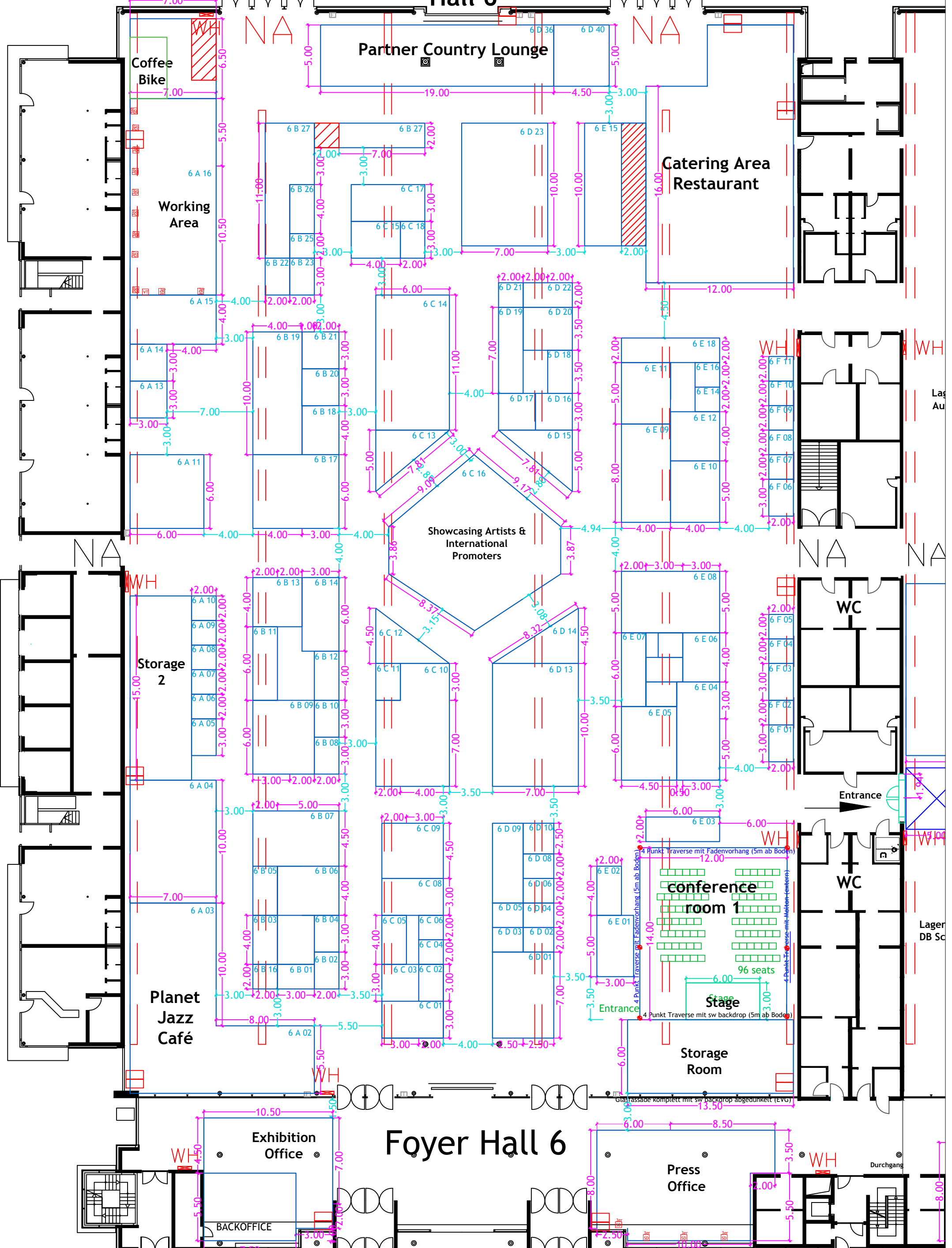

Partner Country Lounge

Coffee Bike

Working Area

Catering Area Restaurant

Showcasing Artists & International Promoters

Storage 2

Planet Jazz Café

Exhibition Office

Foyer Hall 6

conference room 1

Stage

Storage Room

Press Office

Hall 7

Smoking area

Entrance

WC

WC

WH

Durchgang

Lag Au

Lager DB Sc

NA

NA

NA

NA

WC

WH

WH

WH

WH

WH

WH

WH

WH

WH

WH

WH

WH

WH

WH

WH

WH

WH

WH

WH

WH

WH

WH

WH

WH

WH

WH

WH

WH

WH

WH

WH

WH

WH

WH

WH

WH

WH

WH

WH

WH

WH

WH

WH

WH

WH

WH

WH

WH

WH

WH

WH

WH

WH

WH

WH

WH

WH

WH

WH

WH

WH

WH

WH

WH

WH

WH

WH

WH

WH

WH

WH

WH

WH

WH

WH

WH

WH

WH

WH

WH

WH

WH

WH

WH

WH

WH

WH

WH

WH

WH

WH

WH

WH

WH

WH

WH

WH

WH

WH

WH

WH

WH

WH

WH

WH

WH

WH

WH

WH

WH

WH

WH

WH

WH

WH

WH

WH

WH

WH

WH

WH

WH

WH

WH

WH

WH

WH

WH

WH

WH

WH

WH

WH

WH

WH

WH

WH

WH

WH

WH

WH

WH

WH

WH

WH

WH

WH

WH

WH

WH

WH

WH

WH

WH

WH

WH

WH

WH

WH

WH

WH

WH

WH

WH

WH

WH

WH

WH

WH

WH

WH

WH

WH

WH

WH

WH

WH

WH

WH

WH

WH

WH

WH

WH

WH